

J.R. Parrish Inc.
COMMERCIAL REAL ESTATE

jrparrish.com

MAIN OFFICE
831.476.2222
FAX
831.464.5818

9000 Soquel Ave
Suite 200
Santa Cruz, CA 95062

FOR MORE INFORMATION
CONTACT EXCLUSIVE
LISTING AGENT

Rachael Shelton
831.588.8383
rachael@jrparrish.com
DRE# 01916810

Matt Shelton
831.247.1510
matt@jrparrish.com
DRE# 00879054

FOR LEASE OVERLOOK SHOPPING CENTER



1423 MAIN STREET • WATSONVILLE, CA

PROPERTY FEATURES

- 1,200 SF
- Close to Target
- 5/1000 shared parking

- Located in desirable, 270K, regional shopping center with national tenants: Target, Food Maxx, Ross, Staples, Supercuts, Sally's Beauty and GNC



COMMERCIAL REAL ESTATE

jrparish.com

MAIN OFFICE
831.476.2222
FAX
831.464.5818

9000 Soquel Ave
Suite 200
Santa Cruz, CA 95062

FOR MORE INFORMATION
CONTACT EXCLUSIVE
LISTING AGENT

Rachael Shelton
831.588.8383
rachael@jrparish.com
DRE# 01916810

Matt Shelton
831.247.1510
matt@jrparish.com
DRE# 00879054

MAP

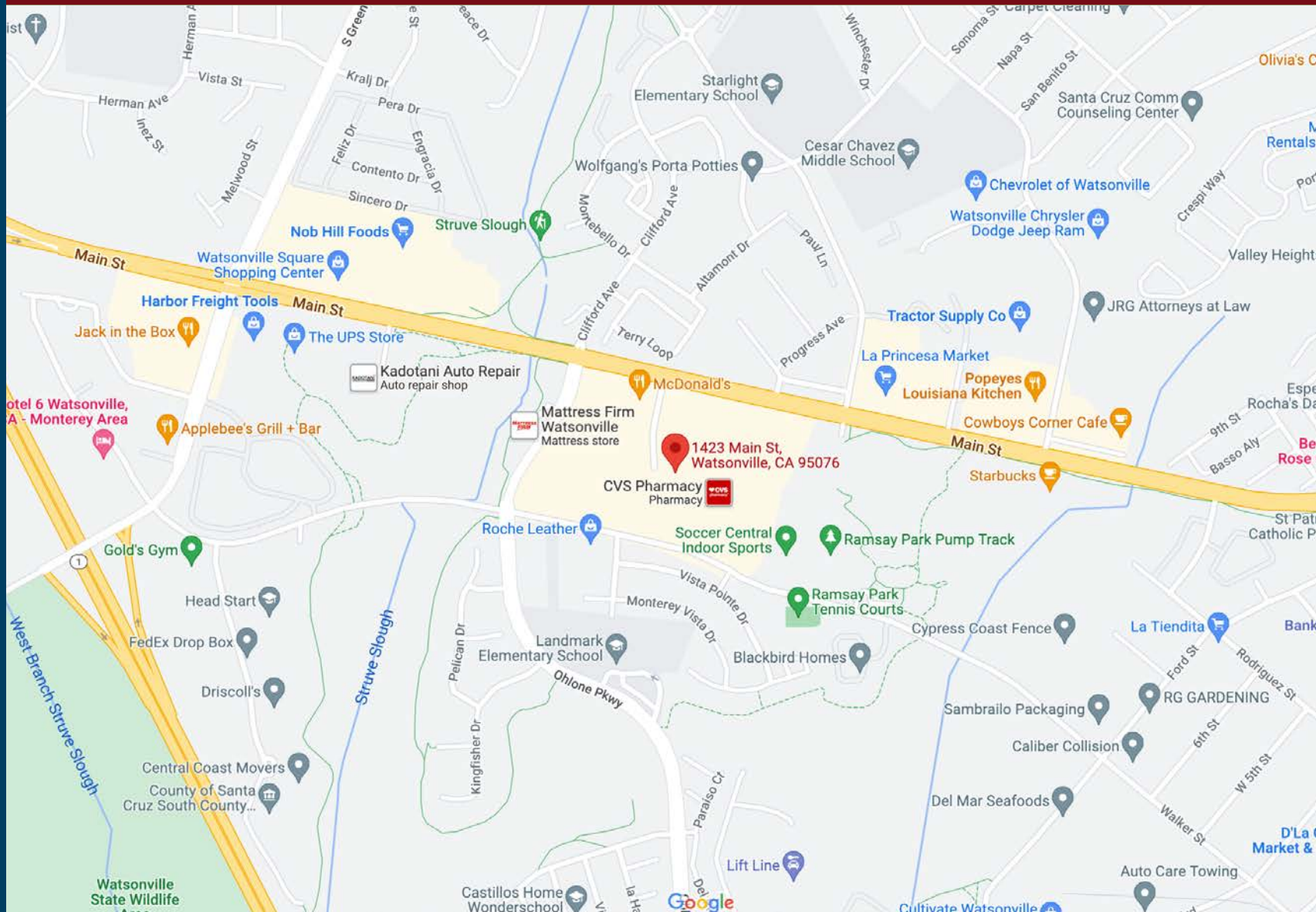

SHOPPING CENTER SITE PLAN

jrparish.com

MAIN OFFICE
831.476.2222

FAX
831.464.5818

9000 Soquel Ave
Suite 200
Santa Cruz, CA 95062

FOR MORE INFORMATION
CONTACT EXCLUSIVE
LISTING AGENT

Rachael Shelton
831.588.8383
rachael@jrparish.com
DRE# 01916810

Matt Shelton
831.247.1510
matt@jrparish.com
DRE# 00879054

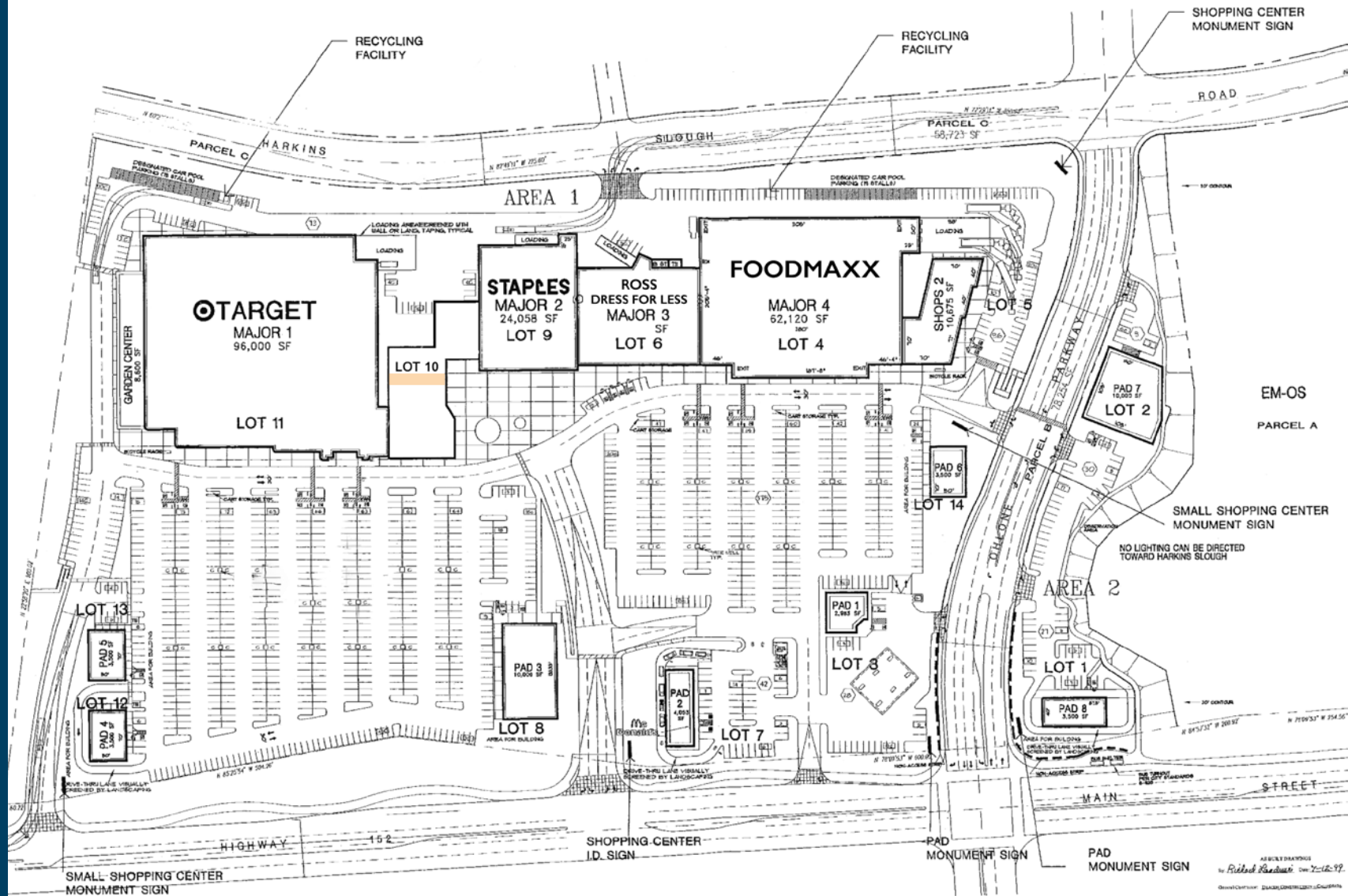

SHOP BUILDING SITE PLAN

jrparish.com

MAIN OFFICE
831.476.2222

FAX
831.464.5818

9000 Soquel Ave
Suite 200
Santa Cruz, CA 95062

FOR MORE INFORMATION
CONTACT EXCLUSIVE
LISTING AGENT

Rachael Shelton
831.588.8383
rachael@jrparish.com
DRE# 01916810

Matt Shelton
831.247.1510
matt@jrparish.com
DRE# 00879054

SHOP BUILDING 1
LOT 10

